

The Dedza Border

Malawi to Mozambique



**An Africa Rally
"How To" Guide**

Introduction

We're back with another useful Africa Rally "How To" Guide, and this time we'll be looking at the Dedza Border crossing between Malawi and Mozambique.

The Dedza Border is becoming more and more popular now that the N304 has been resurfaced with new smooth tarmac, and due to the Zibue border getting busier due to the amount of commercial traffic between Malawi and Mozambique.

As always, this guide has been compiled following first-hand, on the ground research by a member of the Africa Rally Team. It is valid as of July 2024, however note that the expectation is for the Mozambique side of the border to eventually move into the new Main Building shown in Part 1 - so these steps are subject to change in the future.

Reference Map

In order to help visualise the buildings on the ground, and to reference locations from the step by step guide (to follow), we have created this two-part reference map.

Part 1: The Malawi Side

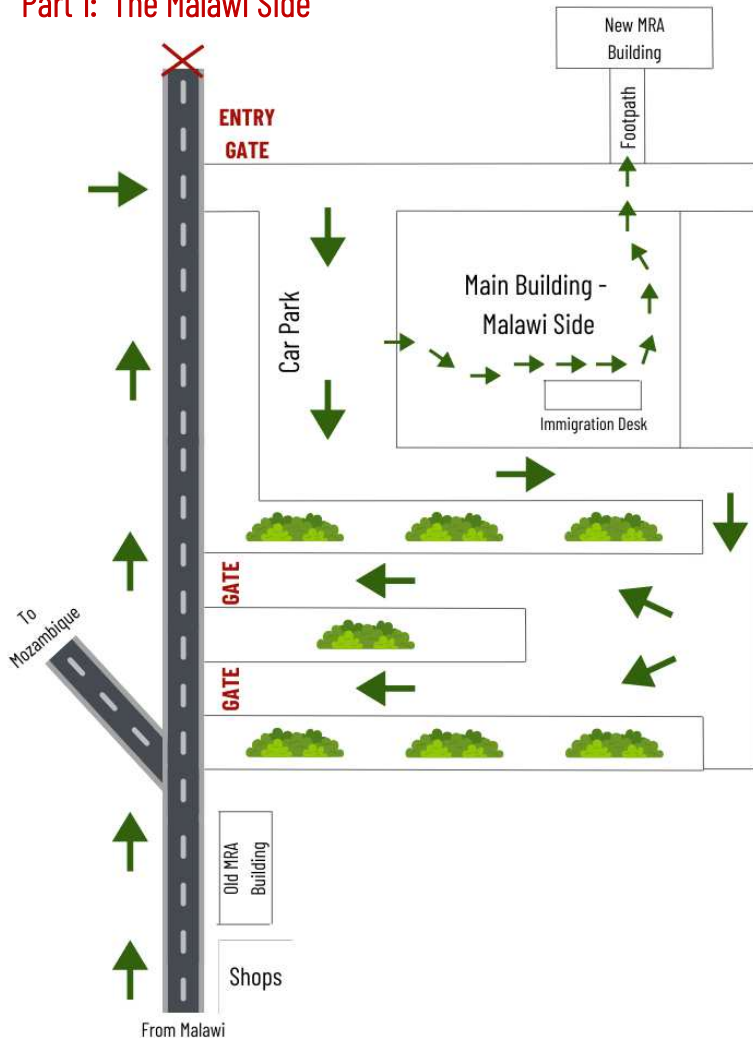

Part 2: The Mozambique Side

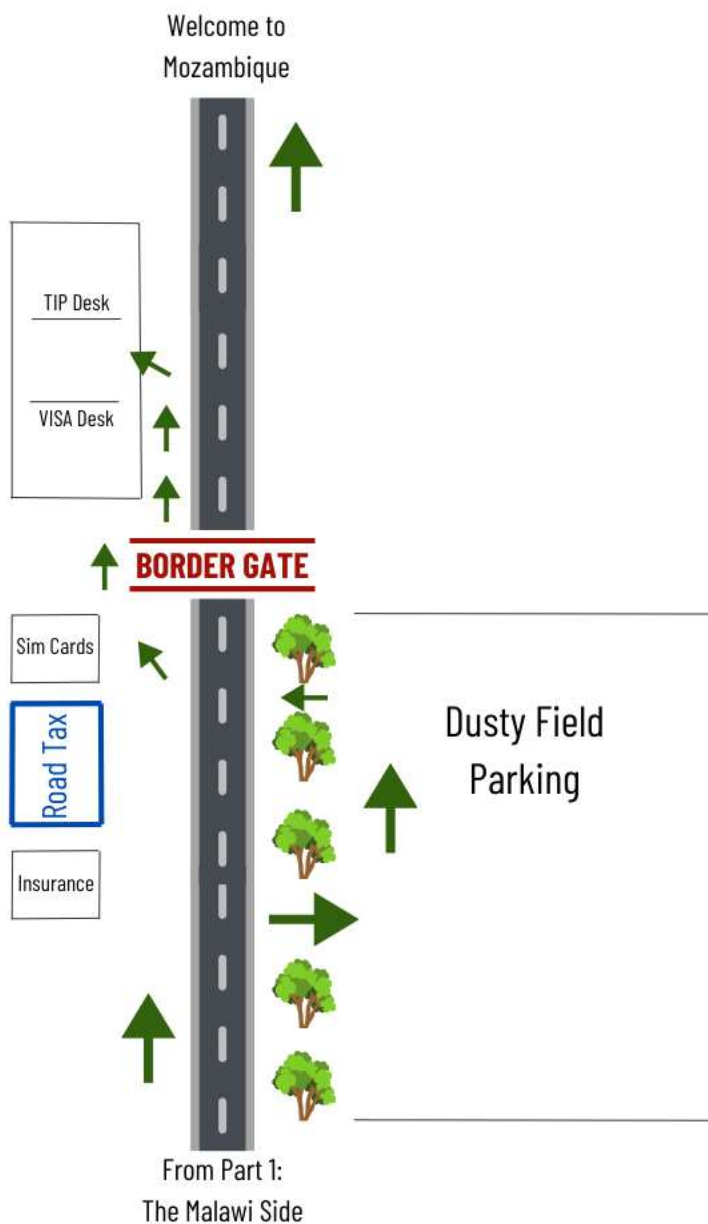

Step by Step Guide

Please note the conditions with which the border were crossed:

- British Passport Holder
- Driving South African Registered Vehicle, in another person's name
- No prior visa, all organised on border

Step 1:

Drive past all the old border shops on the right, including the old MRA (Malawi Revenue Authority) building shown on the map. Ignore the old sign for the Border Post which seems to be pointing you towards a gate. This is now the exit gate.

Additionally, drive past the Mozambique left turn, until you come to a final gate on your right. Turn in here then park up on the right hand side in front of the new white building. Shown as the Main Building on the map.

Step 2:

Walk into the Main Building through the right hand side door and walk ahead to the Immigration desks. The building is so new the signs aren't up yet, (at time of

writing) but it will be the only window with people at, to receive your Malawi exit stamp.

Step 3:

Once you have the exit stamp in your passport, walk through the building and exit through side door as indicated on the map. Turn right then immediately left onto a footpath, and into the new MRA (Malawi Revenue Authority) building.

Step 4:

Walk up to the desk and give them your TIP (Temporary Import Permit) and Road Tax documents that you got on arrival in Chipata, (for Africa Rally Teams, or your relevant point of entry to Malawi for everyone else). Now fill in the book while they tick you off the system and stamp your documents. You'll get these back when they are done.

Step 5:

Return to your vehicle, exit round the right hand side of the Main Building, then keep turning right until you reach the exit gates you drove past earlier. They will check your passport, look at the TIP exit stamps (be clear to them you are exiting), then proceed down the road marked "To Mozambique" on the map.

Step 6:

You'll see a barrier across the road. Unlike with most borders that have an enclosed space, this one barrier is in fact the border itself, so don't drive up to it, instead turn right into the dusty field and find a spot to park underneath a shaded tree.

Step 7:

Get out of your vehicle and walk past the barrier, then head for the large single story building on the left. On the way in you'll be passed a small Visa form to fill in, and the officials will be happy if you can fill this in with your own pen, out of the way of the entrance of the building.

Step 8:

With your newly filled in Visa form, now enter the building and go to the desk on the left (immigration). It may still have the Malawi sign up, as this building was previously both sides of the border, but simply ignore this, you are in the correct place.

Hand them your passport and the slip.

Step 9:

While they are processing this, you may ask if you can complete the TIP (Temporary Import Permit) at the same time. They said yes to our team, however we got the feeling it was only because we asked nicely.

Should they agree, then leave them to process the Visa and walk to the other side of the room. Here you need to fill in all the documents for the vehicle.

Note: **THE TEMPORARY IMPORT PERMIT IS FREE.** It used to cost, however this has been removed, so if you've employed a "helper" - not recommended - they'll probably try to charge you for this.

Step 10:

Once the TIP is stamped, go back to get your passport from the visa desk, and you'll need to pay 650 meticals, or about \$10. Local currency is preferred but they will take USD. Your passport will be stamped and you've got 30 days in Mozambique.

Step 11:

Walk outside with all of your documents, back past the barrier, and now go to the blue hut marked **Road Tax** shown on the map. Pay \$10 and get a blue road tax document. This document and the receipt for your visa

stamp are both very important as they will be stamped at various police and military checkpoints as you drive across Mozambique – **DON'T LOOSE THEM!**

Step 12:

The building next door to the Road Tax building (shown on map) is an insurance place. Our Team paid \$25 for 30 days cover on Mozambique roads for the 1980 Ford Cortina. This is probably cheaper if paid in Meticals, but they didn't seem to push the price and by our maths everyone was paying roughly that amount.

Step 13:

On returning to your vehicle, perhaps use this opportunity to change some cash from USD / Rand to Meticals. Most of the toll gates, and bridge tolls on the main road south will only take cash, and you'll pass two before coming across an ATM in Tete where you can draw cash locally.

If you want to change Kwacha, USD, Rand, or even Euro you'll be able to do it at an acceptable rate as there are usually many individuals competing for foreign currency business in the car park. Just be careful to count precisely what you have been given to avoid any "slight of the hand" scams.

Step 14:

Drive up to the barrier with all of your documents out, they'll check the stamps, then...

Welcome to Mozambique! You've now got 100kms of beautiful new tarmac ahead of you to enjoy!

A Note on Copyright

This "How To" Guide is copyrighted to Africa Rally Group, however it's creation is designed to help all overlanders in their stress free crossing of the Dedza Border between Malawi and Mozambique.

In this case, please feel free to share the information provided, so long as Africa Rally Group (www.africarally.com) is correctly cited / linked, and it is not used for commercial gain. Should you wish to publish this for commercial gain, please reach out to the Africa Rally Team on info@africarally.com

Safe travels!